

LAMP. PANEL HANGER AUH NEW



- Panel can be easily attached / detached without tools.
- Distance to wall is only 5 mm.
- The panel-side and wall-side components are made of the same material for easier handling and management.
- Continuous panels can also be installed easily.
- Can prevent warping of large size panels.
- Mounting holes can be set in the groove of screw guide (see drawing).
- Countersunk-hole specification reduces additional machining work.
- Plasterboard pin set available for easy plasterboard mounting.

Remarks

- Be sure to install panel to wall made from strong materials.
- When using the plasterboard pin set, it cannot be used in combination with the AUH-C70 CATCH fitting.
- We recommend installation with two sets (top and bottom).

Applications

- Exhibition panels, paintings, furniture

Recommended Screw

- Countersunk tapping screw 4

Panel Installation

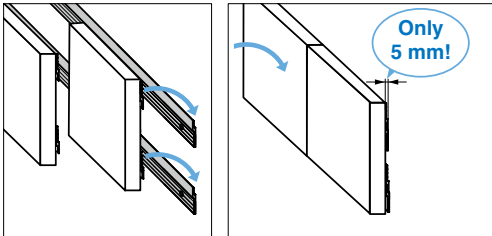

Easy Installation of Panels on The Wall

Attach the hangers to the wall side and panel side with screws, and hang them by hooking the concave and convex parts.

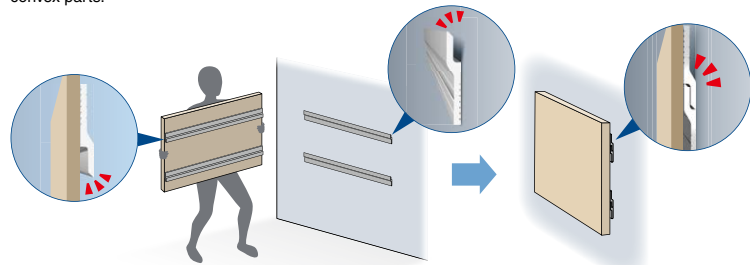

Without Countersunk Holes

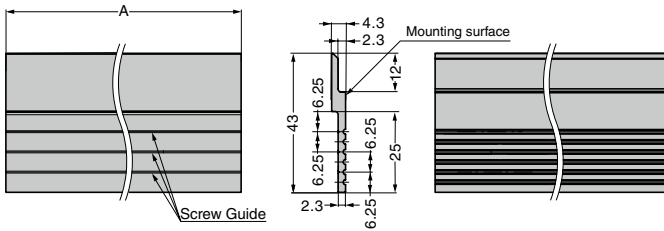

Cut Out Dimensions

Mounting holes should be located symmetrically to the centre of mounting surface, with the pitch below 300 mm.

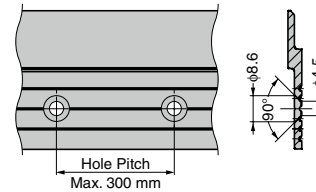

Installation

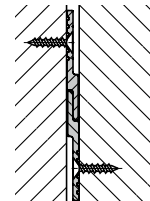

With Countersunk Holes

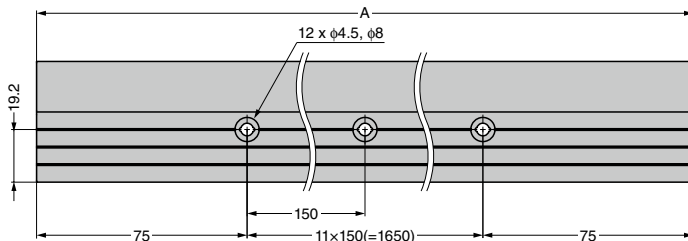

Load Capacity Conditions

The load capacity is the value when a panel with a height of 900 mm, width of 700 mm, and thickness of 25mm (load is at the center of the thickness) is installed using two sets (top and bottom, 780 mm apart) of this product (A dimension 700 mm state) with recommended hole processing. Please note that this varies depending on the distance from the wall to the center of the panel thickness and the panel material.

Application Example



Body

Item Code	Item Name	Countersunk Hole	A	Material	Finish	Load Capacity kgf	Load Capacity N	Carton (pcs)
110-021-888	AUH-900	None	900	Aluminium Alloy	Silver Anodising	30	294.2	10
110-023-958	AUH-2700		2700					10
110-058-757	AUH-1800A	Yes	1800					10

Screw (Sold Separately)

Item Code	Item Name	Item Name	Qty	Material	Finish / Colour
110-058-759	TAP435P50	Countersunk Tapping Screw 4x35	50 pcs	Steel	Bright Chromate (Trivalent)



The product information pertains to the quality standards of the component itself and does not guarantee the performance or safety of the final product in which it is used.